

BT5950

Ø1.5" POLE ADAPTOR FOR SYSTEM 2 Ø2" CEILING MOUNTS

The BT5950 is a pole adaptor from B-Tech's System V Range; a collection of components designed for the installation of CCTV and other ceiling mounted equipment. Designed for use with BT5935 Ø1.5" poles, the adaptor expands the mounting flexibility of System V by allowing the use of specialist Ø2" System 2 mounts for angled ceilings, purlins, I-beams, girders and trusses. Adding compatible B-Tech mounting interfaces and accessory collars to mount CCTV dome cameras and other AV equipment such as flat screens, allows users of System V to create custom ceiling mounted solutions that suit their specific needs.

SPECIFICATIONS

External dimensions	3" x 2"
Color	White

FEATURES

- 1 0.1" heavy-duty steel supports substantial loads with minimal movement
 - 2 Pole adaptor allows System 2 ceiling mounts to be used with System V poles
 - 3 Ideal to use with System 2 mounts such as BT7808, BT7012, BT7017 & BT7825
 - 4 Safety bolt and grub screws secure adaptor to poles and ceiling mount
- Multiple grub screws allow micro-adjustment of the pole to ensure a perfectly angled drop
 - Integrated cable management for cables to pass through poles and adaptor
 - Create a variety of ceiling mounted CCTV installs using System V's range of components



SYSTEM V



BT5950

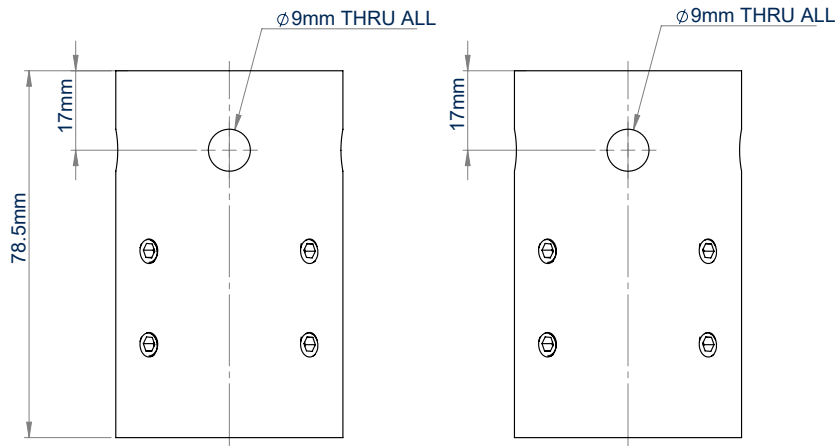

FRONT VIEW

SIDE VIEW

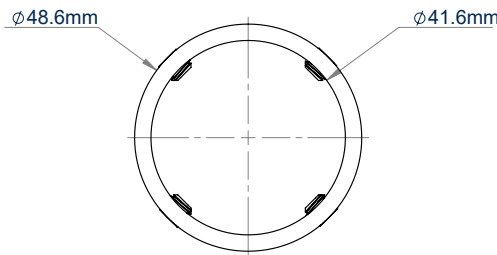

TOP VIEW

ORDERING INFORMATION

COLOR	ORDER REF	BARCODE
White	BT5950/W	5019318304095

RELATED PRODUCTS

PRODUCT CODE	NAME	DESCRIPTION
BT5935	Ø1.5" Poles	Available in 1 metre or 2 metre lengths
BT5910	Dome Security Camera Mount	Carousel mount for small / medium dome CCTV cameras
BT7808	Ceiling / Wall Mount with Tilt	For the suspension of pole mounted solutions from flat or angled ceilings
BT7017	I-Beam / Girder Mount	For the suspension of pole mounted solutions from I-Beam girders

© 2025 B-Tech AV Mounts Co. Ltd. All rights reserved.
 The information in this specification sheet reflects the current technical specifications at the time of printing.
 We reserve the right to change the technical or physical specifications without prior notice. The B-Tech name and the B-Tech logo are registered trademarks of B-Tech AV Mounts Co. Ltd.
 B-Tech is not responsible for any loss or damage caused by improper installation or mounting on unsuitable structures. Any reproduction or reuse of this specification sheet is strictly prohibited unless prior written permission is granted by B-Tech AV Mounts Co. Ltd. 2025.

SS-V1-BT5950/W-210725