



STAND
HEIGHT
31"

BT608

ATLAS™

SPEAKER STANDS

33" (PAIR)

AV AWARDS 2017
MANUFACTURER OF THE YEAR
WINNER

Supplied in pairs these Atlas floor stands are designed for speakers up to 33lbs. Mounting the speakers at a height of 33", the BT608 is easy to assemble and the columns can be filled with sand for sound dampening. Stable on any flooring, the stands are supplied with sound isolating spikes and floor discs to protect wooden/ tiled floors, alternative foam pads are also included.

SPECIFICATION

Max load	33lbs (15kg)
Stand height	31"
Top plate dimensions	4.92" x 4.92"
Base plate dimensions	9.45" x 9.45"

FEATURES

- Twin columned floor stands for loudspeakers
- Fillable columns for superior dampening
- Solid construction using heavy gauge steel for enhanced stability
- Top and bottom isolation spikes provided
- Foam pads included as an alternative to isolating support spikes
- Suitable for all types of floors including wood & carpet with supplied protection discs
- Compatible with SONOS® Play:1
- Supplied in pairs

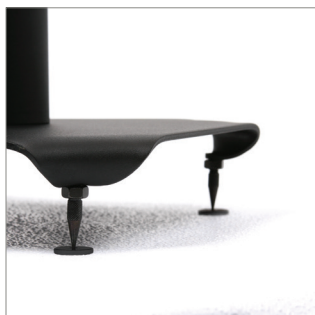

Bottom isolation spikes supplied with floor protection discs



Supplied with isolation spikes and alternative foam pads



Use dry sand to fill columns for superior dampening



Supplied in retail packaging - ideal for the consumer market

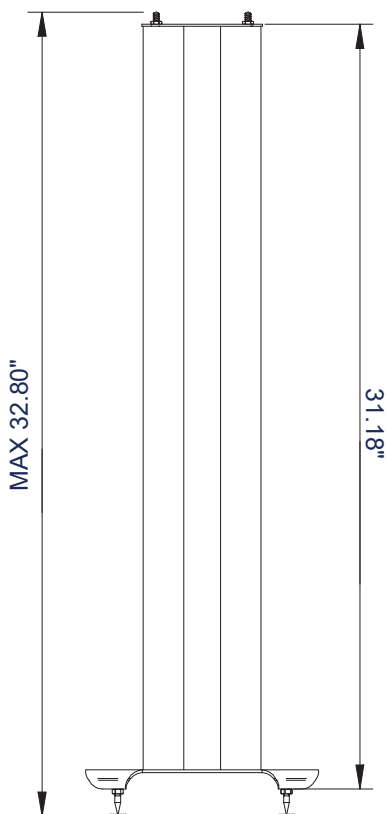

FRONT VIEW

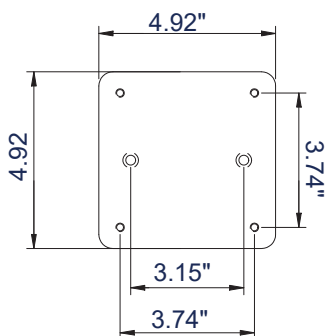

TOP PLATE

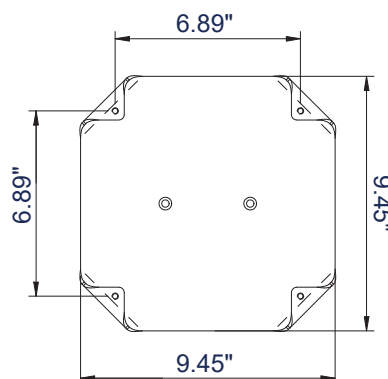

BASE PLATE

PACKING INFORMATION

COLOR:	ORDER REF:	UPC CODE:	MASTER CARTON QTY:	MASTER CARTON CUBE:	CARTON WEIGHT:
Black	BT608/B	811867033014	2	15.19cuft (0.43cbm)	37lbs (17kg)

RELATED PRODUCTS

BT604



Atlas Speaker Stands Height 17"
Designed to mount speakers up to 110lbs

BT606



Atlas Speaker Stands Height 25"
Designed to mount speakers up to 77lbs

BT15



Centre Speaker Wall Mount with Adjustable Arms designed to mount speakers up to 33lbs

BT77



Side-Clamping Speaker Wall Mounts designed to mount speakers up to 55lbs