

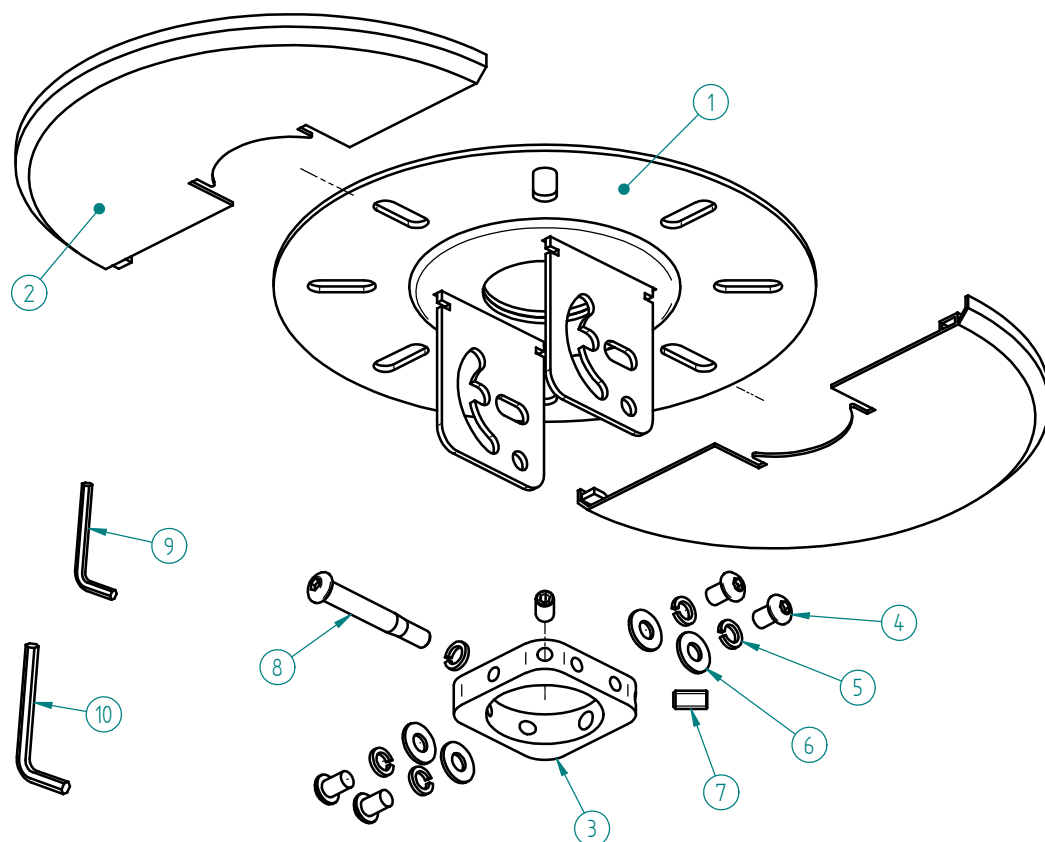

BT7821

50MM POLE CEILING MOUNT



PARTS LIST

No	PART NAME	DESCRIPTION	QTY
1	CEILING MOUNT PLATE	FIXES TO THE CEILING	1
2	COVER PLATE HALF	FITS OVER MOUNT PLATE	2
3	BT7050 ACCESSORY COLLAR	TO FIT 50MM POLES	1
4	M8 X 12 CROSS HEAD SCREW	TO FIX COLLAR TO MOUNT	4
5	M8 OD13 T2 SPRING WASHER	SITS UNDER SCREW HEADS	5
6	M8 OD19 T1.6 PLAIN WASHER	BETWEEN COLLAR + PART 5	4
7	M8 X 15 GRUB SCREW	CLAMPS COLLAR TO POLE	2
8	M8 X 65 SAFETY BOLT	PASSES THROUGH POLE	1
9	4mm ALLEN KEY	TO TIGHTEN PART 7	1
10	5mm ALLEN KEY	TO TIGHTEN PART 4	1

PLEASE KEEP THIS PARTS LIST FOR FUTURE REFERENCE

COPYRIGHT 2006
B-TECH INTERNATIONAL LIMITED, CROYDON, CR0 9UG, UK
www.b-tech-int.com