

BT9240-SP

dVLED VIDEOWALL ROW HEIGHT ADJUSTMENT SPACER FOR SYSTEM XPRESS

The **BT9240-SP** is a component of **B-Tech's System Xpress** range, designed to provide accurate spacing between dVLED mounting rails and to speed up installations. Simply fix the bottom rail, then use the spacers to accurately set the height of the second, third rail etc. Reusable and supplied in pairs, the universal spacers work with the most common cabinet sizes, and can be used for single and double row spacing. The tool-less vertical adjustment is easy to use and once the clamp height is set using the cabinets as a guide, lock the Spacer onto the rail with a simple turn and click. Engineered for fast and efficient assembly, the BT9240-SP should be used in conjunction with System Xpress dVLED videowall mounting kits.

SPECIFICATIONS

Suitable for cabinet heights	250mm up to 1270mm
Compatible with common cabinet sizes	250, 337.5, 343, 500mm
Compatible with portrait cabinets	up to 610mm
Supplied in Pairs	

FEATURES

- 1 Features a simple to use design, 'click' to lock spacer onto rail
 - 2 Tool-less clamp height adjustment for a straightforward assembly
 - 3 Speeds up rail mounting for single and double rows by eliminating the need for measuring during installation
 - 4 Ensures accurate and consistent row height alignment of horizontal rails on dVLED videowalls
- Universal spacer fits the most common cabinet sizes
 - Adjustable clamps adapt to different environments, e.g. when working close to a ceiling
 - Suitable for both landscape and portrait installations
 - Compatible with BT8392 and BT8390 Mounting Rails
 - Reusable for multiple installations
 - **100% plastic free packaging**

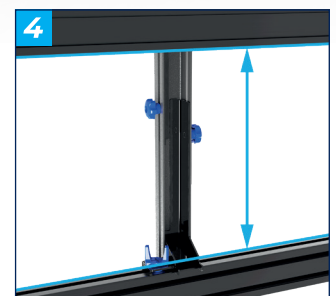
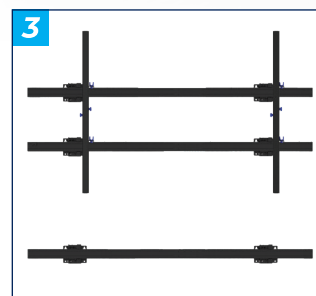
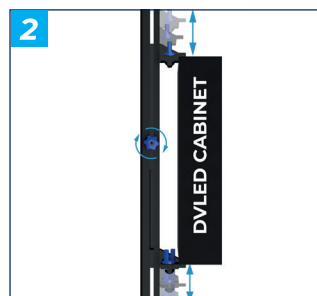
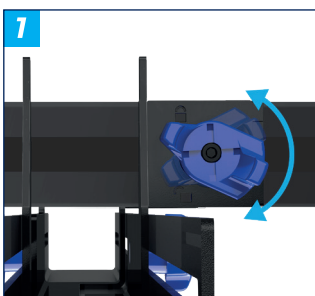
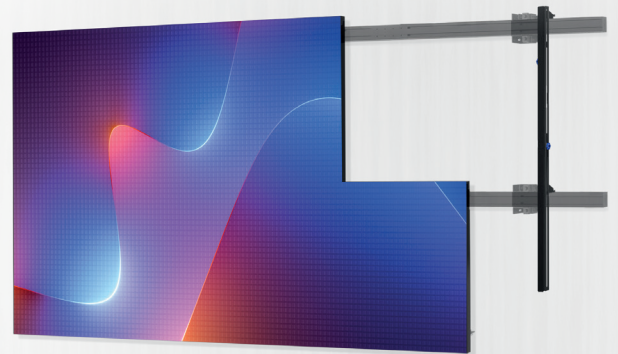

BT9240-SP

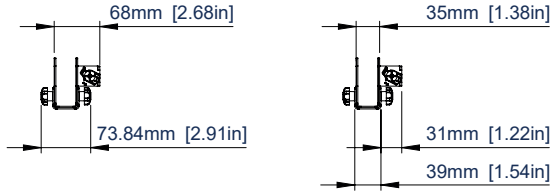

TOP VIEW

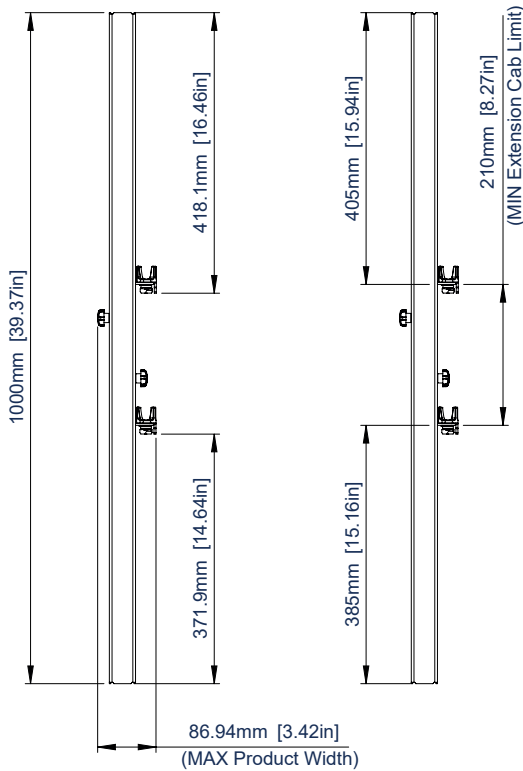

FRONT VIEW

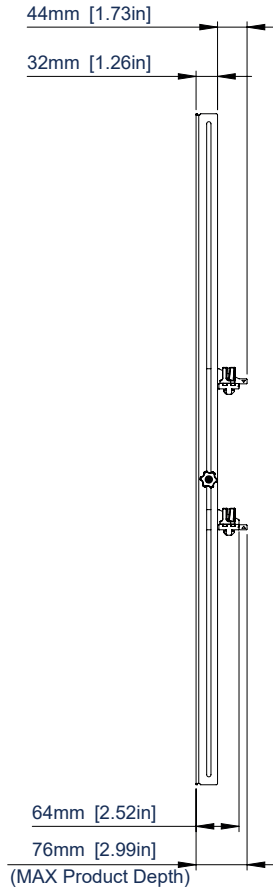

SIDE VIEW

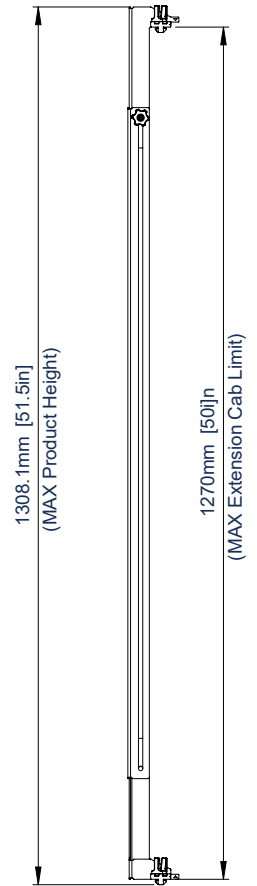

**SIDE VIEW
FULL EXTENSION**

ORDERING INFORMATION

COLOUR	ORDER REF	EAN
Black	BT9240-SP-B	5019318309694

RELATED PRODUCTS

PRODUCT CODE	NAME	DESCRIPTION
BTXPS27-W	System Xpress Universal 27" dvLED Wall Mount	4x4, 5x5, 6x6 & 8x8 pre-configured kits for 27" dvLED cabinets
BTXPS27-S	System Xpress Universal 27" dvLED Floor Stand	4x4, 5x5, 6x6 & 8x8 pre-configured kits for 27" dvLED cabinets
BTXPS27-M	System Xpress Universal 27" dvLED Mobile Stand	4x4, 5x5, 6x6 & 8x8 pre-configured kits for 27" dvLED cabinets
BTXPS27-B	System Xpress Universal 27" dvLED Bolt-Down Stand	4x4, 5x5, 6x6 & 8x8 pre-configured kits for 27" dvLED cabinets

© 2025 B-Tech AV Mounts Corporation Ltd. All rights reserved.
The information in this specification sheet reflects the current technical specifications at the time of printing.
We reserve the right to change the technical or physical specifications without prior notice. The B-Tech name and the B-Tech logo are registered trademarks of B-Tech AV Mounts Corporation Ltd.
B-Tech is not responsible for loss or damage caused by improper installation or mounting on unstable structures. Any reproduction or use, extension or modification of any part of this specification sheet is strictly prohibited unless prior written permission is granted by B-Tech AV Mounts Corporation Ltd.

SS-V1-BT9240-SP-300925