

# BTF844

## UNIVERSAL TWIN SCREEN VC STAND

The **BTF844** is a premium mounting solution designed to mount two screens side by side for video conferencing applications. A heavy duty steel base eliminates the need to bolt to the floor and adjustable levelling feet are included to accommodate uneven surfaces. The high-end aesthetic with an anodised aluminum finish and integrated cable management ensures finished installations are neat and tidy, making the BTF844 ideal for use in corporate environments.

### SPECIFICATIONS

Recommended screen size	<b>39" - 46"</b>
Max screen width	<b>42"</b> per screen
Max load (per screen)	<b>66lbs</b>
VESA® & non-VESA fixings	up to <b>400 x 400</b>
Dimensions	W : <b>59.2"</b> x D : <b>23.8"</b> x H : <b>72.7"</b>
Color options (column & rails)	<b>Black or Silver</b>

### FEATURES

- 1 Supplied with adjustable levelling feet to accommodate uneven floor surfaces
  - 2 Includes VC shelf which can be fixed above or below the screen (VC camera sold separately)
  - 3 Collar compatible accessories such as shelves (available separately) can be fitted directly to the column
  - 4 Integrated cable management for a neat and tidy installation
- Suitable for mounting two screens side by side
  - Heavy duty steel base construction provides stability
  - Can also be bolted to the floor to prevent unauthorized removal of the display
  - Arms feature levelling screws to adjust the screen height
  - Safety screws help prevent unauthorized screen removal
  - Simple 'hook-on' screen installation

## SYSTEM X

RECOMMENDED MAX SCREEN	MAX LOAD	MAX VESA	POST INSTALL ALIGNMENT	COLOR OPTIONS	
46" 116cm	66lbs	400	← →	● ○	

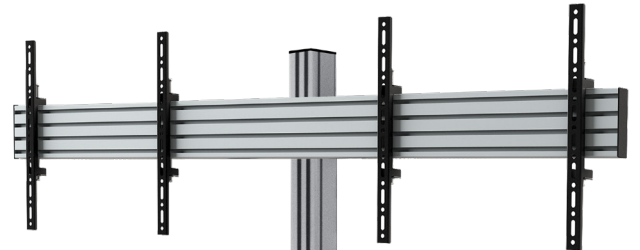

# BTF844

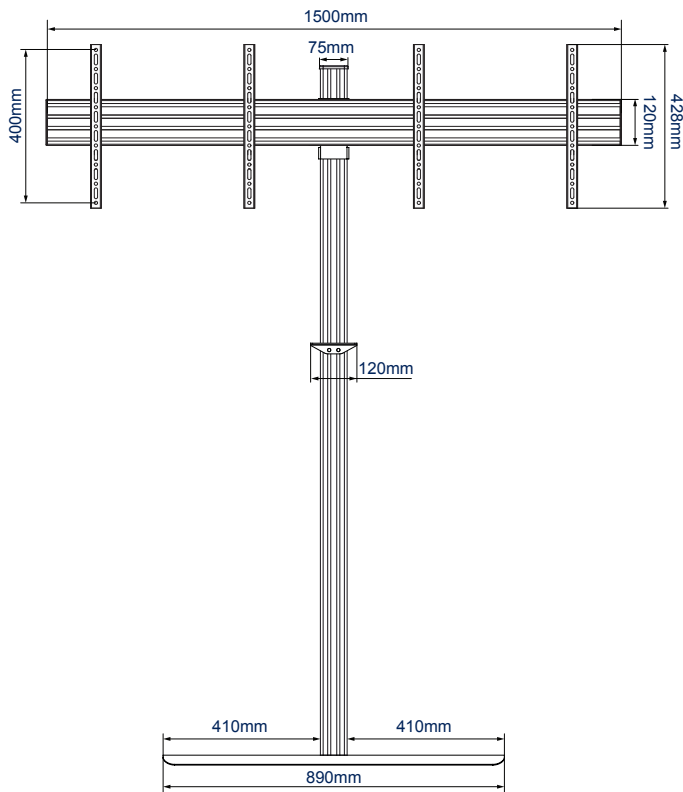

FRONT VIEW

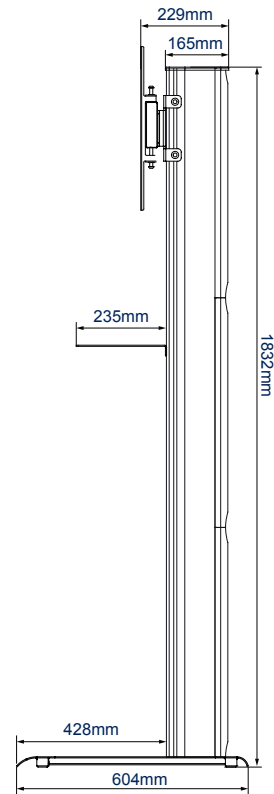

SIDE VIEW

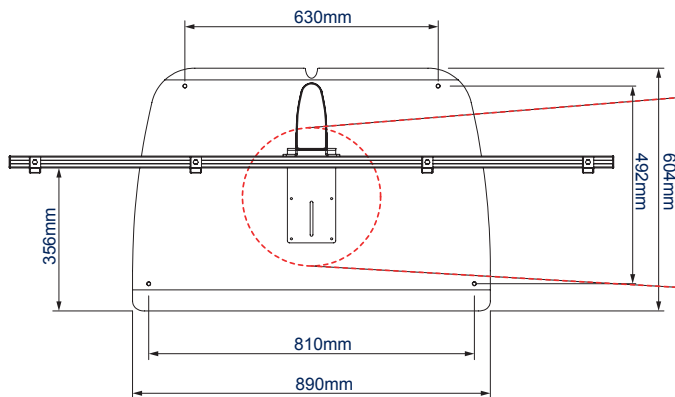

TOP VIEW

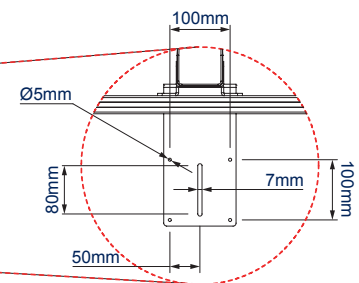

VIDEO CONFERENCE CAMERA  
SHELF CLOSE UP

## ORDERING INFORMATION

COLOR	ORDER REF	EAN
Black	BTF844/BB	5019318087622
Silver	BTF844/BS	5019318087639

## RELATED PRODUCTS

PRODUCT CODE	NAME	DESCRIPTION
BT7032	Large AV Accessory Shelf	Designed to add AV accessories to an installation / wall
BT8390-VESA400T	VESA 400 Interface Arms	Designed to mount medium / large sized screens in a tilted position
BTF841	System X Dual Stack Floor Stand	Designed to mount two screens, one above the other, in portrait or landscape
BTF845	System X Twin Screen VC Stand	Designed to mount two screens, side by side, in landscape